APPLYING TO COLLEGE AND SIXTH FORM FROM OASB

GUIDE TO COLLEGES AND SIXTH FORMS IN
LAMBETH, WESTMINTSER, SOUTHWARK AND
BEYOND

Options for post-16 study



A-Levels

These are more academic studies and you would focus on a few subjects in depth. This would normally be done at a Sixth Form but some colleges also offer them.

To study A-Levels you will usually need get grade 6s in the subjects you want to study at A-Level and sometimes also in English and Maths.

Oasis Academy South Bank has a Sixth Form and if you want to study academic A-Levels this should be your first choice! OASB offers facilitating subjects at A-Level which top universities ask for .

Vocational Qualifications

These are usually courses related more to the world of work and usually are studied at a college.

The qualifications are called BTEC Level 1/2/3 or T-Levels

Work-based qualifications

You develop the skills and knowledge needed to do a particular job.

These are called apprenticeships or traineeships

All students at OASB must apply to a minimum of three post-16 places.

These three applications must be completed by Christmas of year 11.

Did you know?

It is possible to do a combination of A-Levels and Level 3 BTECs at some colleges and Sixth Forms

You can go on to some universities if you study BTEC Level 3 or T-Level qualifications

What Level Should I Apply For?



Level 8	Doctorate			
Level 7	Master's Degree			Master's Degree Apprenticeship
Level 6	Degree			Degree Apprenticeship
Level 5		Foundation Degree	HND	Foundation Degree Apprenticeship
Level 4			HNC	Higher Apprenticeship
Level 3	A Levels	L3 Extended Diploma	T Levels	Advanced Apprenticeship
		L3 Subsidiary Diploma		
Level 2	GCSE grades A*-C (or 4-9)	L2 Diploma		Intermediate Apprenticeship
Level 1	GCSE grades D-G (or 1-3)	L1 Certificate/ Diploma		
	Academic	Vocational		Apprenticeship

<u>BTEC Level 1</u>	<u>BTEC Level 2</u>	<u>BTEC Level 3</u>	<u>Apprenticeship</u>	<u>T-Levels</u>	<u>A-Levels</u>
If you have been achieving GCSE grades 1-2s in mock exams	If you have been achieving GCSE grade 2-3s in mock exams	If you have been achieving GCSE grades 4-5s in mock exams	If you have been achieving GCSE grade 1-4s in mock exams and know a specific vocational career you want to work in	If you have been achieving GCSE grades 4-5s in mock exams and know a specific vocational career you want to work in (more classroom time than apprenticeship)	If you have been achieving GCSE grades 5-6+ in mock exams

Did you know?

All students that have not achieved a grade 4 or above in Maths and English at GCSE will have to continue to study these post-16. when at college or Sixth Form

You should be achieving within one grade of the entry requirements in your mocks to consider applying for a particular place

How do I choose a college or Sixth Form?

Make sure to use this check list when narrowing down the course and place for you

There are lots of things to consider when choosing the right place to go to study after school and these can be very personal to you but here are some important things to research before you apply:

- **Does it offer the level you want?** Generally Sixth Forms will offer A-levels and colleges BTECs but there is some crossover
- **Does it have the entry requirements that match what you have been getting in your mock exams?** If it is asking for 6s in subjects then you won't get a place if you have been getting 3s and 4s in your mocks!
- **Does it offer the subjects you want?** Can you study the subjects you need for your dream job or university place? Remember not all degrees require you to have studied that subject before (e.g. you don't have to have done law A-Level to do Law at university)
- **Has it got a good track record?** Do other students that have been there say good things about it? Does it have a good Ofsted rating? Does it have students leaving to go on to good university places or jobs?
- **Where is it?** Is it close enough to home that you will be able to commute every day?
- **What extra-curricular offering does it have?** Can you play the sports you want to play or join the clubs or societies you want to get involved in?

Ofsted Ratings Explained



Each page in this guide will tell you the Ofsted rating of a school or college. This page will explain what these mean

- Grade 1: Outstanding
- Grade 2: Good
- Grade 3: Requires Improvement
- Grade 4: Inadequate

- An **Outstanding** school will receive Grade 1 for most if not all inspection categories, meaning they provide the highest quality education and care for their children. They will also not receive a Grade 3 or Grade 4 in any category.

Schools which receive an Outstanding rating are exempt from regular Ofsted inspections – they will not be inspected again unless concerns are raised or some very specific conditions are met.

- A **Good** school will receive Grade 2 for most if not inspection categories, with one or two categories rated Grade 1 or Grade 3. Good schools will provide for all their pupils' educational needs, and prepare them well for the next stage in their lives.

Good schools usually receive a short, one-day inspection from Ofsted once every four years. They will only be put through a full school inspection if there is a dramatic fall in performance.

- A school rated **Requires Improvement** will receive a Grade 3 in most inspection categories. These schools still provide an acceptable quality of education and care for children, but will have areas where they could improve.

Schools rated Requires Improvement usually have another full Ofsted inspection within two years of their last inspection (the official government guidance says 30 months but it is almost always sooner).

- If a school is rated **Inadequate**, it has received a Grade 4 in most inspection categories, and a Grade 3 for Leadership and Management. This means the school is failing to provide an acceptable quality of education and care for children and will need to make significant improvements immediately.

Progress 8 ratings explained

Each page in this guide will tell you, where available, the progress 8 score of a school or college. This page will explain what these mean

A school's Progress 8 score is usually between -1 and +1. A score of +1 means that pupils in that school achieve one grade higher in each qualification than other similar pupils nationally. A score of -1 means they achieve one grade lower.

If a school or college has a progress 8 score of 0 then all students on average achieve their expected grades.

If it has a progress 8 score of -1 then students on average achieve 1 grade below their expected grade in every subject.

If it has a progress 8 score of +1 then students on average achieve 1 grade above than their expected grade in every subject/

The average Progress 8 score of all secondary schools nationally is 0. Schools with a Progress 8 score of below -0.5 are not achieving the minimum standard expected by the Government. A score of +0.5 or above shows that pupils in that school are making well above the expected level of progress.

Ofsted judgements by P8 score

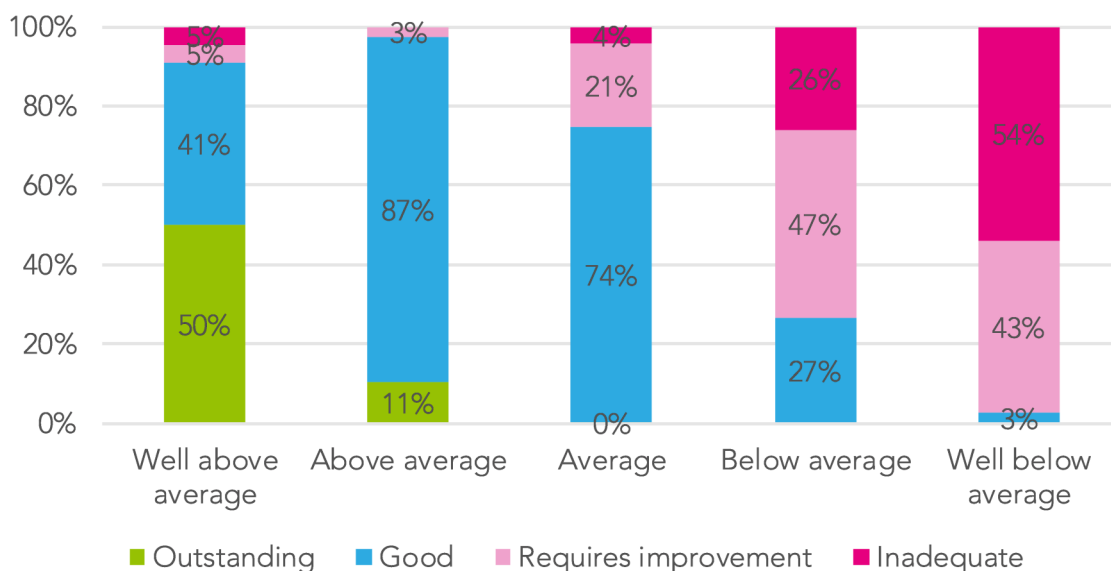

Colleges and Sixth Forms in Lambeth

You can study at a range of colleges and Sixth Forms in Lambeth.

Remember that most schools have attached Sixth forms but some are stand – alone institutions

Where to find Lambeth post-16 provision

Sixth form

- 1 Bishop Thomas Grant Catholic Secondary School
- 2 Dunraven School
- 3 The Elmgreen School
- 4 The Elms Academy (formerly known as Lambeth Academy)
- 5 Harris Clapham Sixth Form
- 6 King's College London Mathematics School
- 7 La Retraite 6
- 8 Lilian Baylis Technology School
- 9 The London Nautical School
- 10 The Norwood School
- 11 Oasis Academy
- 12 South Bank UTC
- 13 St Martin-in-the-Fields High School for Girls
- 14 Trinity Academy
- 15 Woodmansterne

Further education colleges

- South Bank Colleges:
- 16 Lambeth College – Brixton Centre
 - 17 Lambeth College – Clapham Centre
 - 18 London South Bank Technical College

Special schools

- 1 Elm Court School
- 2 Lansdowne School
- 3 The Michael Tippett School
- 4 The Michael Tippett College
- 5 Turney School
- 6 Vanguard

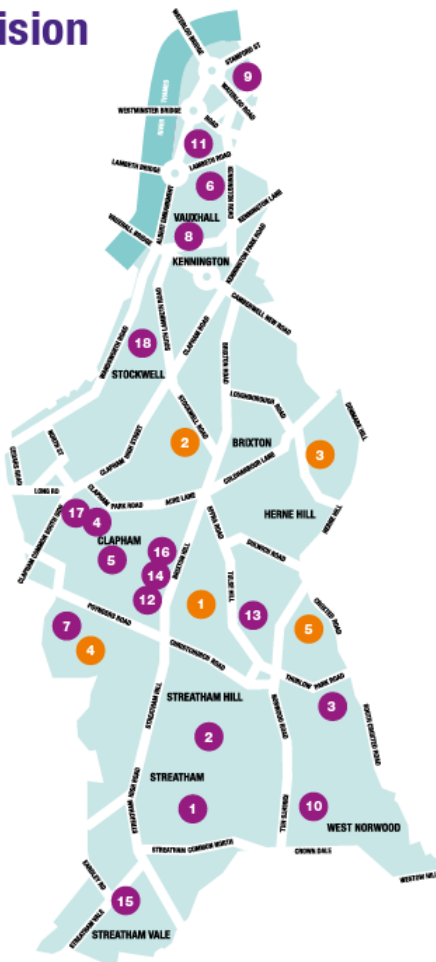

Where you can attend sixth form



Bishop Thomas Grant School
Belltrees Grove, SW16 2HY
020 8769 3294
www.btg.ac
Twitter: @BTGSixthForm



Dunraven School
94/98 Leigham Court Rd, SW16 5SR
020 8696 5600
www.dunraven.org.uk
Twitter: @Dunraven_School



The Elmgreen School
Elmcourt Road, SE27 9BZ
020 8766 5020
<https://www.the-elmgreen-school.org.uk/>
Twitter: @elmgreenschool



The Elms Academy
Elms Road, SW4 9ET
020 7819 4700
www.theelmsacademy.org.uk
Twitter: @TheElmsAcademy (Formerly known as Lambeth Academy)



St Martin-in-the-Fields High School For Girls
(Mixed sixth form)
155 Tulse Hill, SW2 3UP
020 8674 5594
<http://www.stmartins.academy>
Twitter: @smithsfg



Harris Clapham Sixth Form
73 Kings Avenue, SW4 8DX
0204 542 4900
<https://www.harrisclaphamsixthform.org.uk/>
Twitter: @HAClaphamSixth



King's Math School
80 Kennington Rd, SE11 6NJ
020 7848 7346
www.kingsmathsschool.com
Twitter: @kingsmathschool



La Retraite 6 (Mixed Sixth Form)
Atkins Road, SW12 0AB
020 8673 5644
<https://sixthform.laretraite.co.uk/>
Twitter: @LaRetraite6



Lilian Baylis Technology School
323 Kennington Lane, SE11 5QY
020 7091 9500
www.lilianbaylis.com
Twitter: @LBTS_SCHOOL



Trinity Academy
57 Brixton Hill, SW2 1QS
020 3126 4993
<https://www.trinity.futureacademies.org>
Twitter: @TrinityAcad



The London Nautical School
61 Stamford Street, SE1 9NA
020 7928 6801
www.ins.org.uk
Twitter: @londonnautical



The Norwood School
Crown Dale, SE19 3NY
020 8670 9382
www.thenorwoodschool.org
Twitter: @NorwoodLambeth



Oasis Academy
75 Westminster Bridge Rd, SE1 7HS
020 7921 4200
<https://www.oasisacademysouthbank.org/>
Twitter: @OasisSouthBank



South Bank UTC
For students aged 14 – 19 years of age
56 Brixton Hill, SW2 1QS
020 7738 6115
<https://www.southbank-utc.co.uk/>
Twitter: @SouthBankUTC



Woodmansterne School & Sixth Form
Woodmansterne Road, SW16 5UQ
020 87641825
www.woodmansterne.london
Twitter: @WoodySchool

The next few pages will profile some of the colleges and Sixth Forms in Lambeth that have previously been popular with OASB students. These profiles should give you an idea of what information to look up for other colleges you might be interested in. These pages do NOT cover all the colleges in Lambeth or all the factors that may make a college or Sixth Form right for you.

Make sure to do your own research!

Sixth Forms and Colleges in Lambeth - Quick guide

Remember that the best place to find more information is the school /Sixth Form/ college website.

You can compare schools on the government website - just search "Find and compare schools in England" and then search using your postcode and click '16 to 18' .

Destination Name	Post-code	Website	Best for	Specialist subjects	Required Grades
Oasis Academy Southbank	SE1 7HS	www.oasisacademysouthbank.org	Academic A-levels	Sciences, Maths, Economics, History, Geography, English	Grade 6 in chosen subjects Grade 5 in Maths and English
King's College Maths School	SE11 6NJ	www.kcl.ac.uk/mathsschool	Academic A-levels	Maths, Computing, Economics, Physics	Grade 8/9 in Maths
Dunraven School	SW16 5SR	www.dunraven.org.uk	Academic A-levels	Sciences, Arts, Sport BTEC	Grade 7 in chosen subjects Grade 5 in Maths and English
The Elmgreen School	SE27 9BZ	www.the-elmgreen-school.org.uk	Academic A-levels	Arts	Grade 6 in chosen subjects Grade 5 in Maths and English
Lilian Baylis Technology School	SE11 5QY	www.lilianbaylis.com	A-levels and BTEC Level 3	BTEC Business, BTEC Sport	Grade 5 in chosen subjects Grade 4 in Maths and English
The Norwood School	SE19 3NY	www.thenorwoodschoo.org	A-levels and BTEC Level 3	BTEC Arts	Grade 5 in chosen subjects Grade 4 in Maths and English
South Bank Engineering UTC	SW2 1QS	www.southbank-utc.co.uk	A-levels and BTEC	STEM subjects , BTEC Engineering, BTEC Health & Social Care	Grade 6 in chosen subjects Grade 5 in Maths and English
The Elms Academy (used to be Lambeth Academy)	SW4 9ET	www.lambeth-academy.org	A-levels	Sciences, Languages, Humanities	Grade 6 in chosen subjects Grade 5 in Maths and English
The London Nautical School	SE1 9NA	www.lns.org.uk	A-levels	Football Academy	Grade 6 in chosen subjects Grade 5 in Maths and English
St Martin's in the Fields High School for Girls	SW2 3UP	www.stmartins.academy	Academic A-levels	Sciences, Maths & Computer Science, Languages	Grade 6 in chosen subjects Grade 5 in Maths and English

Destination Name	Post-code	Website	Best for	Specialist subjects	Required Grades
Bishop Thomas Grant Catholic Secondary School	SW16 2HY	www.btg.ac	Academic A-Levels and BTEC Level 3s	Facilitating A-Levels + a range of BTECs	Grades 7s in chosen subjects for A-Levels Grade 5s for BTECs
Harris Clapham Sixth Form	SW4 8DX	harrisclaphamsixthform.org.uk/	Academic A-Levels	Facilitating A-Levels, some BTECs	Grade 6/7s in chosen subjects
La Retraite 6	SW120A B	https://sixth-form.laretraite.co.uk/	T Levels	A-Levels, T Levels, Cambridge Technicals	Course dependent
Trinity Academy	SW2 1QS	https://www.trinity.futureacademies.org	Academic A-Levels	Sciences and Maths	Grade 6s/7s in chosen subjects
Woodmansterne School & Sixth Form	SW16 5UQ	http://www.woodmansterne.london	A-Levels, BTECs and Cambridge Vocationals	Cookery—cooking school and Arts A-Levels	Grade 5/6s in chosen subjects
Lambeth College	Brixton - SW2 1QS Clapham SW4 9BL	https://www.lambethcollege.ac.uk/	BTEC Level 3 BTEC Level 2	Health & Social Care, Sport Business, Hair & Beauty, Hospitality, Construction	Grade 4 in Maths Grade 4 in English Lower grades accepted for Level 2

OASIS ACADEMY SOUTH BANK SIXTH FORM

Postcode: SE1 7HS

Ofsted Rating and previous results

Outstanding

Latest A-Level: 70% A*-B

Progress 8 at GCSE: +0.77
(including early English Literature Results) - Well above average

Multiple successful applicants to Russel Group Universities

Average grade—A-Levels: B

What they say about themselves

Oasis Academy Sixth Form opened its doors in September 2018 after its lower school was rated outstanding by Ofsted and producing GCSE results in the top 1% of the country.

We maintain our exceptionally high standards which have led to outstanding academic success offering courses in some of the most challenging traditional A-level subjects available.

What current students say

"The best thing about my course is that I get to study interesting things that can really help me in my future"

"You have a feeling of independence to set you up for work like and personal life in your future"

"I would not want to change anything about it"

"The teachers are always willing to support me and there is a good professional and nice atmosphere to work in"

"The sixth form is tailored to our needs because the teachers are already familiar with our abilities and are able to give us the help we need to get the grades we want"

"The sixth form provides opportunities for us to network and form contacts with potential employers through enrichment programmes"

What they specialize in

Academic A-Level subjects required by Russel Group universities. E.g. Biology, Physics. Economics, Maths, Further Maths

Approximately 7 hours of teaching per subject with a specialist teacher (significantly above national average)

Enrichment opportunities and links with companies and organisations to boost your personal statements and applications.

What grades you will need

Grade 6s or 7s in the subjects you want to study plus grade 5s in English and Maths

All OASB students that want to do A-levels should be applying here as one of their options!



The building

Notes:

Do I want to make this one of my three options? Yes/No

Do I have the grades I need at the moment? Yes/No

What subjects do I need to improve in to successfully apply?

Have I submitted my application? Yes/No

KING'S COLLEGE MATHS SCHOOL

Postcode: SE11 6NJ

Ofsted Rating and previous results

Outstanding

Average result—A-Level: A*

A*-A: 99.6% of results

75% of students achieved straight A*s

What they say about themselves

King's Maths School is for students aged 16-19 with a particular aptitude and enthusiasm for mathematics, and aims to widen participation in mathematical degrees and careers at the very best universities and institutions.

King's Maths School is run in partnership with King's College London, and is the first of many specialist mathematics schools opening around the country with the support of leading universities.

What they specialize in

Students that are interested in studying Maths in the future

They offer A-Levels in Maths, Further Maths, Physics, Economics

The King's Certificate—a 12 week research project set by academics

What grades you will need

Grade 8 or 9 in GCSE Maths, grade 7/8/9 in Physics or grade 7/7 in combined science

Grade 5 or above in five other GCSEs

What current students say

"Maths is presented as an adventure! Every time we are introduced to a new topic, it becomes a journey to find a formula or the rule."

"Maths is a foundation. The things we are taught here will better equip us for degrees in computing, engineering and physics."

"The structure of teaching is exciting. The teachers encourage students to find out more. They would guide you to find the answer yourself."



The building

Notes:

Do I want to make this one of my three options? Yes/No

Do I have the grades I need at the moment? Yes/No

What subjects do I need to improve in to successfully apply?

Have I submitted my application? Yes/No

DUNRAVEN SCHOOL

Postcode: SW16 2QB

Ofsted Rating and previous results

Outstanding

Progress 8 Score
(secondary): -0.24(average)

Average result—A –Levels:
B

Average—Broad Vocational
Level 3 Qualifications:
Distinction+

Students secure university
places at Russell Group
Universities.

What they say about themselves

Our aim is 'Excellence for All' in the Dunraven community - staff, students and families. I believe this is demonstrated through our commitment to the education of the whole student; our staff team work hard to deliver both academic excellence, and excellence in character education, as demonstrated by the wealth of opportunities on offer to our students. The sixth form team dedicate time and effort to ensuring every student has support to access the next step on their journey, whether that's university, an apprenticeship place, or another destination.

Our strength is in our community, and I believe we have a fantastic team here; staff who are focused on the student experience and the individual journey of each child; families who invest in the education of their young person; students who strive to be the best versions of themselves.

Aims and Ethos

The staff team are relentless in their pursuit of excellent outcomes for students across a broad and balanced curriculum, and supporting them to the next steps on their journey, whether that's a sixth form place, an apprenticeship, or a university place at some of the world's leading institutions.

All staff and students work to provide the best environment for learning. We focus on training teachers to deliver outstanding lessons, developing our feedback to support students' progression, and providing a wide range of experiences for students to enhance their understanding in and out of the classroom.

What they specialize in

A range of academic and arts A-Levels plus sports BTEC

Wednesday afternoon enrichment such as sport and art classes. PHSE and citizenship also delivered.

What grades you will need

6 GCSEs grade 6-9 including English Language and Mathematics

Grade 5 to 7 in subjects you want to study



The building

Notes:

Do I want to make this one of my three options? Yes/No

Do I have the grades I need at the moment? Yes/No

What subjects do I need to improve in to successfully apply?

Have I submitted my application? Yes/No

ELMGREEN SCHOOL

Postcode: SW16 2QB

Ofsted Rating and previous results

Good

Progress 8 Score
(Secondary) :-0.35 (just below average)

Average result for A-Level:
C+/C

Average Result for Vocational Qualifications:
Distinction—

What they say about themselves

The Elmgreen Sixth Form is a creative, vibrant and successful place for students to study and achieve. As a school we are an 'inclusive community' where everybody is encouraged to achieve 'beyond their potential'. This ethos particularly rings true for our students in The Elmgreen Sixth Form.

We offer students a broad and balanced curriculum which is carefully matched to an individual's needs and aspirations. Students follow a number of Pathways, from our Baccalaureate Pathway, for those wishing to attend Russell Group Universities, to a Diploma Pathway which focuses on a more vocational range of qualifications leading to university, work or apprenticeships. The personal nature of our offer reflects the inclusive ideals of the school. We ensure that each student is on the right Pathway for them and is offered maximum opportunities to achieve personal goals and targets.

What they specialize in

A range of academic plus BTEC level 3—
Can study a combination of these

Arts subjects as well as academic ones

A variety of leadership, mentoring and work related opportunities plus enrichment

What grades you will need

Grade 6 minimum in chosen subjects

Grade 5 minimum in Maths and English

What current students say

"I love all the people, I love the energy"

What Ofsted says

"Students value the high quality of support they receive and the positive relationships that they have with their teachers"



The building

Notes:

Do I want to make this one of my three options? Yes/No

Do I have the grades I need at the moment? Yes/No

What subjects do I need to improve in to successfully apply?

Have I submitted my application? Yes/No

LILIAN BAYLIS TECHNOLOGY SCHOOL

Postcode: SE11 5QY

Ofsted Rating and previous results

Outstanding

Progress 8 Score
(Secondary): -0.07 (average)

Average result—A-Levels:
C+

Average result—Broad
Vocational Level 3
Qualifications: Merit +

Average result—T-Levels:
Distinction -

What they say about themselves

LBTS6 is not just about education, it's about starting your career path. We are geared towards students with ambition and drive who will be able to make the most out of our many links with business, industry and numerous London universities. We understand how important the choices you make for years 12 and 13 are in determining your future career prospects. That is why we make our students this simple promise: we will provide you with the opportunities, experiences and guidance to ensure your progression to university and/or into your desired future career.

What current students say

"A few people I knew had applied to LBTS6 and they said so many great things after their interviews, I thought it was worth applying too. What really stood out for me was the amount of support that was on offer and the great results they had been achieving, I knew I didn't want to study 3 A-Levels or do only BTECs, so I was offered the perfect combination"

"There is so much help available in the 6th form, the staff were very encouraging and let me know that I didn't have to feel intimidated or limited in any way. Spanish is my first language, but it didn't occur to me that I could study it as an additional a level until my interview"

What they specialize in

A range of academic plus BTEC level 3—
Can study a combination of these

Contacts, mentors and links to industry.
Employability skills

What grades you will need

To study 4 A-Levels—minimum of seven
GCSEs 7+

To study 3 A-Levels—minimum of five
GCSEs 6+

To study combination of A-Levels and
BTEC—5 GCEs including grade 5 in
closest subject

To study just BTECs—5 GCEs including
English and Maths grade 5



The building

Notes:

Do I want to make this one of my three options? Yes/No

Do I have the grades I need at the moment? Yes/No

What subjects do I need to improve in to successfully apply?

Have I submitted my application? Yes/No

NORWOOD SCHOOL

Postcode: SE19 3NY

Ofsted Rating and previous results

Good

Progress 8 Score
(Secondary): +0.14

Average result—A-Level: B-

Average result—Broad
Vocational Level 3

Qualifications: Distinction -

What they say about themselves

We offer an innovative, creative and exciting post-16 experience. We take a great deal of pride and care in designing a curriculum that provides a number of pathways for students to choose. From STEM subjects, Humanities specialists, Visual and Performing Arts, Business and Enterprise to Sports & Leisure; our pathways are deliberately designed to allow students to specialise as well as combine subjects that complement each other. The quality of teaching and learning is “Good” (last year 99.8% of students passed Level 3 qualifications) and the pastoral care and focus on personalised learning has led to excellent results and success from students gaining places in Russell Group universities to The Guildhall School for Music & Drama as well as placing over 70 % last year into Higher Education.

What they specialize in

Performing and visual arts plus business

Mix of A-Levels and BTEC Level 3s

What grades you will need

A-Levels—minimum of six GCSEs grade 5+, grade 6 in subject of interest

BTEC/A-Level combined pathways—minimum of five GCSEs grade 6+, grade 6 in A-level subject to study

BTEC Level 3— minimum of four GCSEs grade 2+,

What current students say

“My work experience has helped me clarify my career possibilities and has been a really satisfying element of my studies here. I have enjoyed being part of a creative environment here at the Norwood Sixth Form”

“I have had so many opportunities here to visit museum and galleries, have worked with lots of practising artists and have had a real taste of what my future might hold.”

“One of the best things about the Norwood Sixth Form is the work experience opportunities and the links that we have had to world class businesses and organisations.”

“The amount of help I have had with my UCAS application has been great, the time, care and thought that my tutor and head of year have put into guiding me has been invaluable. “



The building

Notes:

Do I want to make this one of my three options? Yes/No

Do I have the grades I need at the moment? Yes/No

What subjects do I need to improve in to successfully apply?

Have I submitted my application? Yes/No

SOUTH BANK ENGINEERING UTC

Postcode: SW2 1QS

Ofsted Rating and previous results

Requires Improvement

Average result—A-
Levels: E+

Average result—Broad
Vocational Level 3
Qualifications: Merit+

Average result—T
Levels: Merit -

What they say about themselves

Our innovative approach to teaching and learning allows creative thinking and develops problem solving skills. It helps to prepare our students for work, higher education and apprenticeships. Integrity is about professional conduct and trust in the quality of our work and the way our students conduct themselves. A clear intent drives forward our ambition to succeed and perform to the highest of our ability.

Future focused

Our academic results continue to be excellent, with students achieving above national average in our BTEC courses. Progress has also improved, with more students moving into academic pathways. These high-quality technical and traditional courses are employability focused. We encourage our students to embrace opportunities and give them the skills needed for work and further education

What they specialize in

Science, Technology, Engineering and Maths

Link to South Bank university

Mix of A-Levels and BTEC Level 3s

Emphasis on workshops and scientific investigations

What grades you will need

A-Level pathway —minimum of five GCSEs 5+, grade 6 in subject of interest

BTEC Level 3 pathway —minimum of five GCSEs 5+

BTEC Level 2 pathway — grade 3 in English and Maths

Life at UTC

More like a workplace than a school

Our students benefit from innovation: we have a longer working day, but do not set homework. All students wear business dress and act in a professional way. Our small size and professional atmosphere means students benefit from closer relationships and high level support.

Project based learning

Our students benefit from project-based learning. These projects give further opportunities to develop skills, enhance progress and give our students the edge. We work with our sponsors to provide opportunities other schools can't.



The building

Notes:

Do I want to make this one of my three options? Yes/No

Do I have the grades I need at the moment? Yes/No

What subjects do I need to improve in to successfully apply?

Have I submitted my application? Yes/No

LAMBETH COLLEGE

Postcode: SW2 1QS

Ofsted Rating and previous results

Good

Average Grade—Broad Vocational Level 3 Qualifications: Merit

Average Grade—T-Levels: Merit—

Apprenticeships: Results suppressed

What they say about themselves

We offer a wide range of high quality courses and apprenticeships that will open the door to future career opportunities in health and social care, construction, ESOL, engineering, hair and beauty, hospitality, sport, media and more. Most of all we will help you become a qualified workready and motivated professional with the skills and confidence to participate in today's competitive job market

Our standards are high with the vast majority of our students going into work, higher education or training. You can expect an excellent experience in terms of teaching, learning, industry links, facilities and study resources. You will be encouraged to take responsibility for your own work and manage your deadlines, to develop independent thinking and learning skills and to work with others to complete activities within your chosen programme of study.

What current students say

"Lambeth college created for me a platform where I could not just only study but also associate myself with a group of colleagues and staff members that are friendly and growth-oriented."

"The one thing that I particularly liked about Lambeth College, is not only the students receive the benefits from their courses, it's the results that count too."

"Lambeth college has been a brilliant place to pursue my studies because I had an immense amount of support, opportunities, and resources as well as my teachers, who always went above and beyond for me to succeed. "

What they specialize in

Apprenticeships and vocational courses

Preparation for world of work

What grades you will need

Level 3— four GCSEs grade 4+

Level 2— two GCSEs grade 3+



The building

Notes:

Do I want to make this one of my three options? Yes/No

Do I have the grades I need at the moment? Yes/No

What subjects do I need to improve in to successfully apply?

Have I submitted my application? Yes/No

Colleges and Sixth Forms in Southwark

You can study at a range of colleges and Sixth Forms in Southwark.

Remember that most schools have attached Sixth forms but some are stand – alone institutions

- ARK Globe Academy
 - ARK Walworth Academy
 - Bacon's College
 - Harris Academy Bermondsey
 - Harris Sixth Form – Homestall Campus
 - Harris Sixth Form – Rye Campus
 - Kingsdale Foundation School
 - Sacred Heart Catholic School
 - South Bank University Academy
 - St Michael's Catholic College
 - St Saviour's & St Olave's School
 - St Thomas the Apostle College
 - The Charter School North Dulwich
 - The Charter School East Dulwich
 - The City of London Academy (Southwark)
- BOSCO**
- Southwark College**



The next few pages will profile some of the colleges and Sixth Forms in Southwark that have previously been popular with OASB students. These profiles should give you an idea of what information to look up for other colleges you might be interested in. These pages do NOT cover all the colleges in Southwark or all the factors that may make a college or Sixth Form right for you.

Make sure to do your own research!

Sixth Forms and Colleges in Southwark - Quick guide

Remember that the best place to find more information is the school /Sixth Form/ college website.

You can compare schools on the government website - just search "Find and compare schools in England" and then search using your postcode and click '16 to 18' .

Destination Name	Postcode	Website	Best for	Specialist subjects	Required Grades
Ark Globe Academy	SE1 6AF	www.arkglobe.org	A-levels	Sciences, Maths, History & Politics, BTEC Business, BTEC Sport	Grade 6 in chosen subjects Grade 5 in Maths and English
City of London Academy	SE1 5LA	www.cityacademy.co.uk/	A–Levels	Wide range of art and science A-Levels	Grade 6 in 5 subjects Grade 5 in Maths and English
Ark Walworth Academy	SE15UJ	http://walworthacademy.org/sixth-form/about-sixth-form	A-Levels + some BTECs	Range of A-Levels BTECs in Business and Arts	Grade 6 in chosen subjects Grade 4 in Maths and English
Bacon's College	SE16 6AT	http://www.baconscollege.co.uk/sixth-form	A-Levels	Range of A-Levels	Grade 6 in 5 subjects Grade 5 in Maths and English
Harris Academy Bermondsey	SE16 3TZ	http://www.harrisbermondsey.org.uk/	Facilitating A-Levels + Business BTEC	Sciences and Humanities A-Levels	Grade 6 in chosen subjects Grade 6 in English and Maths
Harris Sixth Form	Homestall Campus—SE220NR (girls) Rye Campus—SE220A (boys)	http://www.harrisdulwichgirls.org.uk/	Facilitating A-Levels and a range of vocational courses	Combinations of A-Levels and Vocational L3	For 4 A-Levels—Average grade 8 Grade 6 in chosen subjects
Kingsdale Foundation School	SE21 8SQ	http://kingsdalefoundationschool.org.uk/	Wide range of A-Levels, GCSE Resits	A-Levels or a Transition Pathway into A-Levels	Grade 6s/7s in chosen subjects For Transition Pathways need to get grade 4s then retake GCSEs before going to SF
Sacred Heart Catholic School	SE5 0RP	http://www.sacredheart.southwark.sch.uk/	Range of A-Levels and some vocational qualifications	Facilitating A-Levels and Oxbridge Pathway	Grade 5s in 6 subjects including English and Maths Grades 6s/7s in chosen subjects

Destination Name	Postcode	Website	Best for	Specialist subjects	Required Grades
South Bank University Academy	SE17 2TP	http://www.southbankua.org.uk/	A-Levels, some BTECs + GCSE resits	Range of A-Levels including the Arts and EPQ	Grade 6s or 7s in chosen subjects
St Michael's Catholic College	SE16 4UN	http://www.stmichaelscollege.org.uk/	A-Levels and some BTECs	A-Levels alongside Catholic focus and worship	Average Grade 6+ for 4 A Levels Average Grade 5.6+ for 3 A-levels Average Grade 4.6+ for vocational pathway
St Saviour's and St Olave's School	SE1 4AN	http://www.sssosouthwark.sch.uk/	A range of A-Levels, several vocational Level 3s and English and Maths GCSE resits	Range of A-Levels	Grade 6/7s in chosen subjects
St Thomas the Apostle College	SE15 2EB	http://www.stac.uk.com/	A range of A-Levels and EPQ and some vocational courses	A variety of A-Levels	Grade 6s in chosen subjects Seven grades 5-9 including English and Maths grade 6
The Charter School	East Dulwich—SE22 8RB North Dulwich—SE24 9JH	http://www.charternorthdulwich.org.uk/	A range of A-Levels and some BTEC L3	A-Levels including Arts A-Levels	Grade 6s in chosen subjects for A-Levels Five grade 9-4
Southwark College	SE1 8LF	https://www.southwark.ac.uk/	BTEC Level 3 BTEC Level 2	Art Business Dance / drama Health and Social care Sciences Computing Media / Music Travel & Tourism	Grade 4 in Maths Grade 4 in English If lower grades achieved you can still attend but have to resit Maths and English
BOSCO College	SE16 4R	http://www.bosco.ac.uk/	Functional skills L1, 2 & 3, Level 2 and 3 BTECs	Childcare, Hospitality and ICT	Interview dependent

ARK GLOBE ACADEMY

Postcode: SE1 6AF

What they say about themselves

Ofsted Rating and previous results

Good

Progress 8 Score
(Secondary): **+0.48**
(well above average)

Average result (A-Level): **B+**

Average result (Broad Vocational Qualifications):
Distinction*-

Welcome to Ark Globe Sixth Form, where pursuing social justice is at the very heart of who we are and what we do. Preparing students for university and leadership in the community is a bold mission and one we take very seriously in Sixth Form.

We believe that the young people in our community deserve a place in the top universities and apprenticeships of this country. Our destinations speak for themselves, 100% of our students obtained a place at university, 70% of our students obtained a place in a top third university in 2020. Our Sixth Form continues to be in the top 2% of post 16 providers in the UK. So how do we do it?

We are inspirational – Our young people benefit from outstanding teaching and inspiring teachers, coaches and mentors who push our students to go beyond the curriculum.

We are aspirational – Our young people are given access to opportunities, experiences, and networks with those at the very top of their professions. Our students are encouraged to go for the best Universities and apprenticeships.

We have high expectations – Our young people recognise that when the tide rises all the boats go up. The Globe Culture pyramid values are not something simply said, but they are embodied in each member of the community to ensure that no one is left behind. We expect the best so only the best can be given.

What they specialize in

Science, humanities and social science A-Levels

Professional pathway in Business and Sport

What grades you will need

A-Level—five GCES at grade 5+ including English and Maths

BTEC Level 3—five GCSEs at grade 4+



The building

What current students say

“Teachers set the bar higher and planted faith in me”

“Being at Globe, being in a community where people are so confident to express their ideas and also very supportive, changed me.”

“Having teachers and peers who support, celebrate and uplift one another makes all the difference to young people trying to find their footing in our wider society “

“Globe Academy has been essential in creating the environment for me to be able to grow as a person and reach new heights”

Notes:

Do I want to make this one of my three options? Yes/No

Do I have the grades I need at the moment? Yes/No

What subjects do I need to improve in to successfully apply?

Have I submitted my application? Yes/No

CITY OF LONDON ACADEMY (SOUTHWARK)

Postcode: SE1 5LA

Ofsted Rating and previous results

Good

Progress 8 Score
(Secondary): -0.01

Average result (A-Level)— B-

Average result (Broad vocational qualifications):
Distinction-

What they say about themselves

City of London Academy offers students incredible unique opportunities to build links with the City and take the first steps on the road to a successful career.

We are sponsored by the City of London Corporation, an elected body that looks after the business district around St Paul's.

This sponsorship provides CoLA Southwark students the very best experiences of the working world, from shadowing judges at the Old Bailey to work placements at business giants like Ipsos MORI – and even Buckingham Palace.

We aim to instil in every pupil an appreciation of the City, its values and cultures, and an understanding of its different professions and experiences. We want them to leave CoLA prepared for the demands and rigour of working life.

What current students say

“Very fast paced, but nonetheless a fantastic experience. The environment is well built for young, hungry students driven by desire, and support has been great. Blessed to have been part of the sixth form experience at cola, I’m just living life and I hope the same for any student who attends this school. ”

“The fact that my teachers are accessible by email means that I can always receive feedback and improve my work to a higher standard. For me, the Resource Centre at the new site has been the best place to complete work and revise because of the laptops that are available to us at all times, and the positive working environment. Also, we are always informed about insightful opportunities like competitive work experience in 6th form Google Classroom. “

What they specialize in

Work experience and placements

A-Levels—Sciences, Humanities, Arts

BTEC Level 3, BTEC Level 2— Business, IT, Sport

Basketball programme

What grades you will need

A-Level—five GCES at grade 6+, 5+ in English and Maths

BTEC Level 3—five GCSEs at grade 5+, 5+ in English and Maths



The building

Notes:

Do I want to make this one of my three options? Yes/No

Do I have the grades I need at the moment? Yes/No

What subjects do I need to improve in to successfully apply?

Have I submitted my application? Yes/No

SOUTHWARK COLLEGE

Postcode: SE1 5LA

Ofsted Rating and previous results

Good

Average result (A-Level): C+

Average result (Broad General Qualifications) Merit +

Apprenticeship Achievement rate: 58.2%

What they say about themselves

The rest of your life starts here! So what are you going to do with it? Have you always dreamed of becoming a fashion designer, working with children, or making a career on the stage? Or are you not sure what job you'd like to do but know one thing: you don't want it to feel like the standard '9-5'. Either way, our huge range of 16-18 vocational courses will put you on the right track towards a great career.

Forget what you think you know about studying. Here, we match your programme to your ambition. Not only will our talented teachers give you the tools to succeed, you'll learn in a lively environment where your voice is definitely heard. You'll also get the chance to use industry-standard facilities and find out what the real world of work is like as part of your course. It's time to take a leap into the unknown: your future.

What they specialize in

A wide range of vocational courses at all levels e.g. music, media, IT, Health and Social Care, Fashion, Travel and Tourism

What grades you will need

Southwark give offers to most applying as you can enrol on a BTEC Level 1, 2 or 3 or an apprenticeship

If you do not receive grade 4s in Maths and English you will have to resit

Aim of the college

"Southwark College is a thriving, dynamic further education college based in a £41m state-of-the-art campus opposite Southwark tube station. Our aim is to enable students to gain the qualifications, professional skills and confidence they need to achieve their career ambitions. "



The building

Notes:

Do I want to make this one of my three options? Yes/No

Do I have the grades I need at the moment? Yes/No

What subjects do I need to improve in to successfully apply?

Have I submitted my application? Yes/No

Colleges and Sixth Forms in Westminster

You can study at a range of colleges and Sixth Forms in Westminster.

Remember that most schools have attached Sixth forms but some are stand-alone institutions

Colleges and Vocational Establishments:

City of Westminster College

Westminster Kingsway College

Schools and Sixth Forms:

Harris Academy St John's Wood

Harris Westminster Sixth Form

King Solomon Academy

Marylebone Boys' School

Paddington Academy

Pimlico Academy

St Augustine's CE High School

St George's Catholic School

St Marylebone School

The Grey Coat Hospital School

Westminster Academy

Westminster City School

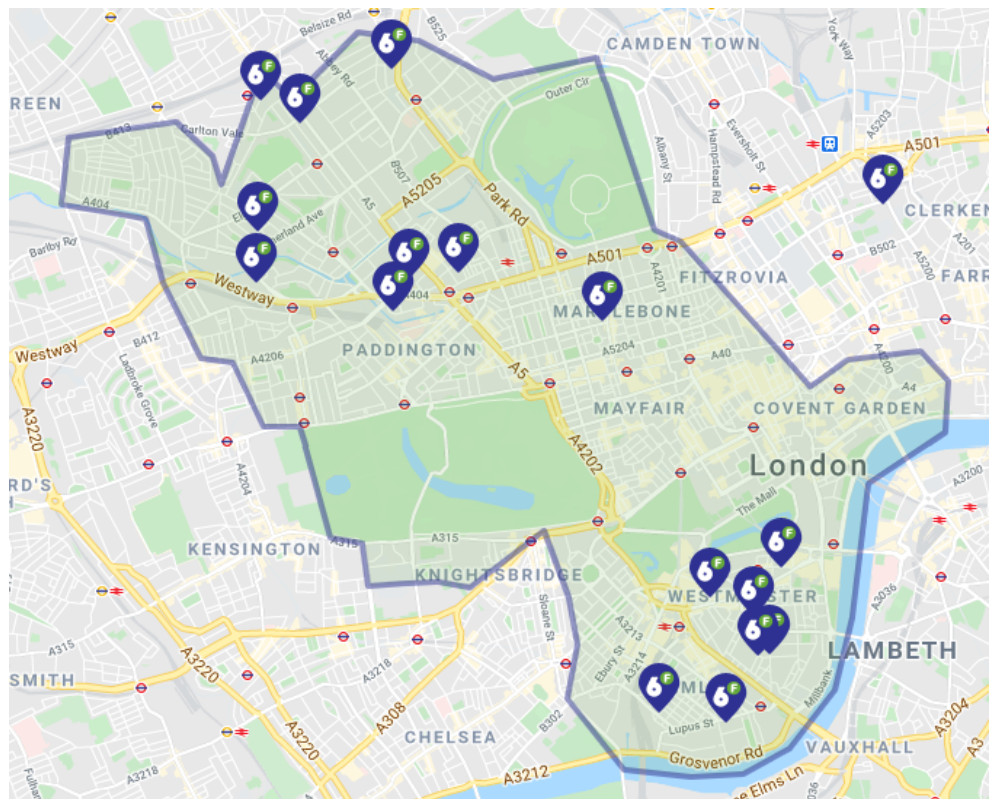

The next few pages will profile some of the colleges and Sixth Forms in Westminster that have previously been popular with OASB students. These profiles should give you an idea of what information to look up for other colleges you might be interested in. These pages do NOT cover all the colleges in Westminster or all the factors that may make a college or Sixth Form right for you.

Make sure to do your own research!

Sixth Forms and Colleges in Westminster - Quick guide

Remember that the best place to find more information is the school /Sixth Form/ college website.

You can compare schools on the government website - just search "Find and compare schools in England" and then search using your postcode and click '16 to 18' .

Destination Name	Postcode	Website	Best for	Specialist subjects	Required Grades
Pimlico Academy	SW1V 3AT	www.pimlico.futureacademies.org	Academic A-Levels	Science, Maths, English, Humanities, Languages, Social Sciences, Arts	Grade 6 in subjects to be studied Grade 5 in Maths and English
Harris Westminster Sixth Form	SW1H 9LH	https://www.harriswestminster-sixthform.org.uk/	Academic A-Levels	Sciences, Arts, Classics, Humanities	Must pass entrance exams Grade 7 in 6 subjects Grade 7 in subject of choice
Westminster Kingsway	Soho - W1F 0HS Victoria - SW1P 2PD Kings Cross - WC1X 8AR	https://www.westking.ac.uk/	A-levels Wide range of BTECs	Performing Arts Hospitality	Grade 5s for Alevels Grade 4s for BTECs Can still attend if lower with Maths and English retakes
City of Westminster College	W2 1NB	https://www.cwc.ac.uk/	Apprenticeships Wide range of BTECs A-Levels	Finance, Media, Construction, Sciences, Travel and Tourism, Sport, Art and design, Business	Grade 4s in six subjects and a 6 in the subject you want to study (A-Levels) Grade 4s in six subjects for BTEC Level 3
Grey Coat Hospital School	SW1P 2DY	https://www.gch.org.uk/sixth-form	Academic A-Levels	Languages and other facilitating A-Levels	5 GCSEs grade 5-9 Grade 6/7 in the subjects you want to study

PIMLICO ACADEMY

Postcode: SW1V 3AT

Ofsted Rating and previous results

Good

Progress 8 Score
(Secondary): +0.54
(above average)

Average result (A-Level): B

What they say about themselves

We offer a rich and stimulating education comprised of a knowledge-rich curriculum, diverse cultural and extracurricular opportunities, and a strong pastoral support system. All children are welcomed in our inclusive community, and all are challenged to be the best they can be. With the support of our sponsors, Future, we are able to engage with the best teachers, the best universities and a wide range of the most prominent employers in the country to ensure that all our children are equipped with the knowledge and desire to be the best in whatever path they wish to follow.

At Pimlico Academy, we place knowledge and the pursuit of excellence at the heart of all that we do. We have the highest expectations of our students and persevere in guiding them to achieve their fullest potential. We believe that knowledge should be joyful and empowering, and we strive to foster in our students an insatiable curiosity for life. We believe that knowledge is an emancipatory force, granting our students the freedom to achieve their academic and social potential. This ethos is embodied in our Trust values (Knowledge, Aspiration, and Respect) and in our school motto, *libertas per cultum* (freedom through education)

What they specialize in

Academic A-Levels

Arts and Social Science A-Levels

University application support

What grades you will need

A-Level—grade 5+ in English and Maths, grade 6 in chosen subject of study

A-Level Maths and Science—grade 7+ in Maths or Science

What the principal says

“Pimlico Academy is a happy and caring community, but one that has scholarship, academic achievement and character development at its heart. Everything that we do is underpinned by our motto, ‘Libertas per cultum’ (‘Freedom through education’). We have an absolute belief in the power of education to empower individuals, to transform lives and to shape a better world. As a matter of social justice, all students, irrespective of background or starting point, have a right to learn about the best that has been thought, known and said. We believe that having access to a first-rate knowledge-rich curriculum, supported by a comprehensive co-curriculum, is a prerequisite to developing understanding, cultural literacy, good character and, ultimately, wisdom.”



The building

Notes:

Do I want to make this one of my three options? Yes/No

Do I have the grades I need at the moment? Yes/No

What subjects do I need to improve in to successfully apply?

Have I submitted my application? Yes/No

HARRIS WESTMINSTER SIXTH FORM

Postcode: SW1H 9LH

Ofsted Rating and previous results

Outstanding

Average result: B+

77% A*-B, 91% A*-C,
20% A*

What they say about themselves

Harris Westminster Sixth Form, which opened in September 2014, combines the strengths of Westminster School in teaching academically able students with the Harris Federation's experience in establishing and running outstanding maintained sector schools across London. Our academic offer, ethos and approach to learning are all highly demanding and present a challenge and opportunity to able students who are keen to make the most of their potential. We are academically selective: successful applicants spend two years with other able and ambitious students being stretched in lessons and provided with encouragement and opportunity to extend themselves out of lessons so that they are fully equipped to gain places at, and then succeed in, the top universities in the UK and abroad.

After two years of outstanding education and personal development Harris Westminster students are not just ready to face the world but to change it. They are prepared for study at the best universities in the UK and abroad and learn how to get the most out of their experiences at those great institutions.

What they specialize in

Highly academic programmes with a fast pace of learning

Arts, Literature, Humanities, Maths, Science

All students must study four A-Levels

What grades you will need

To pass an academic entrance exam and interview

Six grade 7+s at GCSE minimum

What current students say

"The passion the teachers taught you with is inspirational, as well as how hard they work you. In the end it pays off"

"The teacher makes Maths lessons really interesting; I can see his passion—I want to have that passion"

"I feel like I am learning immense amounts. The pace we're going at is ferocious –it's brilliant because it means that I'm being stretched every day"

"I've had a wonderful time here: it's amazing to look back and see the progress I've made as a student and a person."



The building

Notes:

Do I want to make this one of my three options? Yes/No

Do I have the grades I need at the moment? Yes/No

What subjects do I need to improve in to successfully apply?

Have I submitted my application? Yes/No

WESMINSTER KINGSWAY COLLEGE

Postcode: SW1P 2PD

Ofsted Rating and previous results

Good

Average result (A-Level):
C

Average result (Broad vocational qualifications):
Merit

Average result (T-Levels):
Merit +

Apprenticeship achievement rate: 66.7%

What they say about themselves

Westminster Kingsway College is one of the largest further education colleges in London and is part of the Capital City College Group, alongside City and Islington College and the College of Haringey, Enfield and North East London.

Our diverse student body of around 14,000 learners come mainly from London, but many travel further afield across the South East and abroad in order to study on our acclaimed vocational and academic courses.

We have four stunning centres across Camden and Westminster, located in the heart of the city in King's Cross, Victoria and Soho, offering an extensive range of academic and vocational courses for all ages.

We offer A Levels, A Level Intensives, vocational courses (diplomas, certificates and awards, including BTECs, University of the Arts London, City & Guilds and more), and higher education courses. From September 2021, we will also run T Levels in Digital and Healthcare Science.

What they specialize in

Culinary arts and sciences, languages, media and digital skills, construction, arts, nursing, music, science, teaching, travel and tourism

Mixes of BTECs and A-Levels

What grades you will need

A-Levels— three GCSEs grade 5+ plus two at 4+, 6+ in subject of study

BTEC Level 3—four GCSEs grade 4+

BTEC Level 2—four GCSEs grade 3+



The building

What current students say

"We are a lot more developing skills in management"

"The college provides a lot of resources with us"

"To come to this college you need a willing to want skills"

"They are teaching us how to make your own style"

"We have good facilities"

"You can speak to everyone and they help you"

"The teachers are so lovely and helpful and the support is immense"

Notes:

Do I want to make this one of my three options? Yes/No

Do I have the grades I need at the moment? Yes/No

What subjects do I need to improve in to successfully apply?

Have I submitted my application? Yes/No

CITY OF WESTMINSTER COLLEGE

Postcode: W2 1NB

Ofsted Rating and previous results

Requires improvement

Average result (A-Level): C-

Average result (Broad vocational qualifications): Merit

Average result (T-Levels): Merit +

Apprenticeship achievement rate: 55.3%

What they say about themselves

We are located in Central London and we are currently the top college for apprenticeships. In addition, we also offer over 200 courses across a wide range of both vocational and academic subjects. City of Westminster College has specialist facilities including, science labs, motor vehicle workshops, photography studios, a theatre and TV and Radio studios.

At City of Westminster College, your teachers will not only help you develop knowledge and understanding, first and foremost they will help you develop skills. These will include:

- Research
- Reading
- Note-making and summarising
- Memory and recall
- Time management
- Organising
- Action planning
- Self-reflection
- Deeper thinking - assessing, analysing and evaluating
- Creative thinking
- Problem solving
- Team working - cooperative working, compromise, negotiation, flexibility, avoiding excessive blaming and taking responsibility
- Resilience – normalising and learning from mistakes

What they specialize in

Mixes of BTECs and A-Levels

Finance, Media, Construction, Sciences, Travel and Tourism, Sport, Art and design, Business, Music,

What grades you will need

A-Levels—Grade 4s in six subjects and a 6 in the subject you want to study

BTEC Level 3—Grade 4s in six subjects for BTEC Level 3

BTEC Level 2—Grade 3 in GCSE English

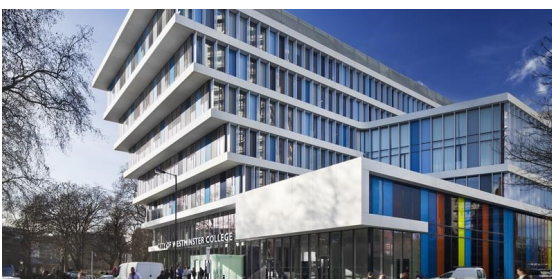

The building

What current students say

“The facilities are really good”

“I definitely recommend this course to anyone”

“The facilities are incredible and so are the teachers

“When I leave college I hope to go to a university”

Notes:

Do I want to make this one of my three options? Yes/No

Do I have the grades I need at the moment? Yes/No

What subjects do I need to improve in to successfully apply?

Have I submitted my application? Yes/No

GREY COAT HOSPITAL SCHOOL

Postcode: SW1P 2DY

Ofsted Rating and previous results

Outstanding

Progress 8 Score Secondary: 1.0

Average result (A-Level): B+

Apprenticeship achievement rate: 81.3%

What they say about themselves

The Grey Coat Hospital, founded in 1698, is a Church of England school for girls aged eleven to eighteen which welcomes boys into the Sixth Form. We are a school with strong values, committed to ensuring that each student is known as an individual, develops the knowledge, skills and personal qualities to lead a successful and fulfilling life, and is empowered to do so.

The aim of The Grey Coat Hospital is “to enable students to take charge of their learning, make decisions based on Christian values, live in the world as independent women and men and meet the challenges of the twenty-first century”. We aim for excellence both in and out of the classroom, seeking to develop the qualities of inquisitiveness, resilience, independence, humility and kindness.

What they specialize in

A-Levels—Languages and other facilitating subjects

Completion of the EPQ

What grades you will need

A-Levels—5 GCSEs Grade 5-9 including English and Maths

Grade 6s/7s in the subject you want to study

Additional Offer

In addition to A-Levels they offer the Level 3 Extended Project Qualification (EPQ) which complements the standard offer of three A levels. This qualification is well regarded by universities and allows students to develop the skills required when studying at undergraduate level; such as independence, research skills, academic writing, presentation skills, project management skills, data analysis and problem solving.



The building

Notes:

Do I want to make this one of my three options? Yes/No

Do I have the grades I need at the moment? Yes/No

What subjects do I need to improve in to successfully apply?

Have I submitted my application? Yes/No

Colleges and Sixth Forms in other boroughs

Some of our students have previously gone to colleges in boroughs further away and there are many more not listed here. Make sure to do your research!

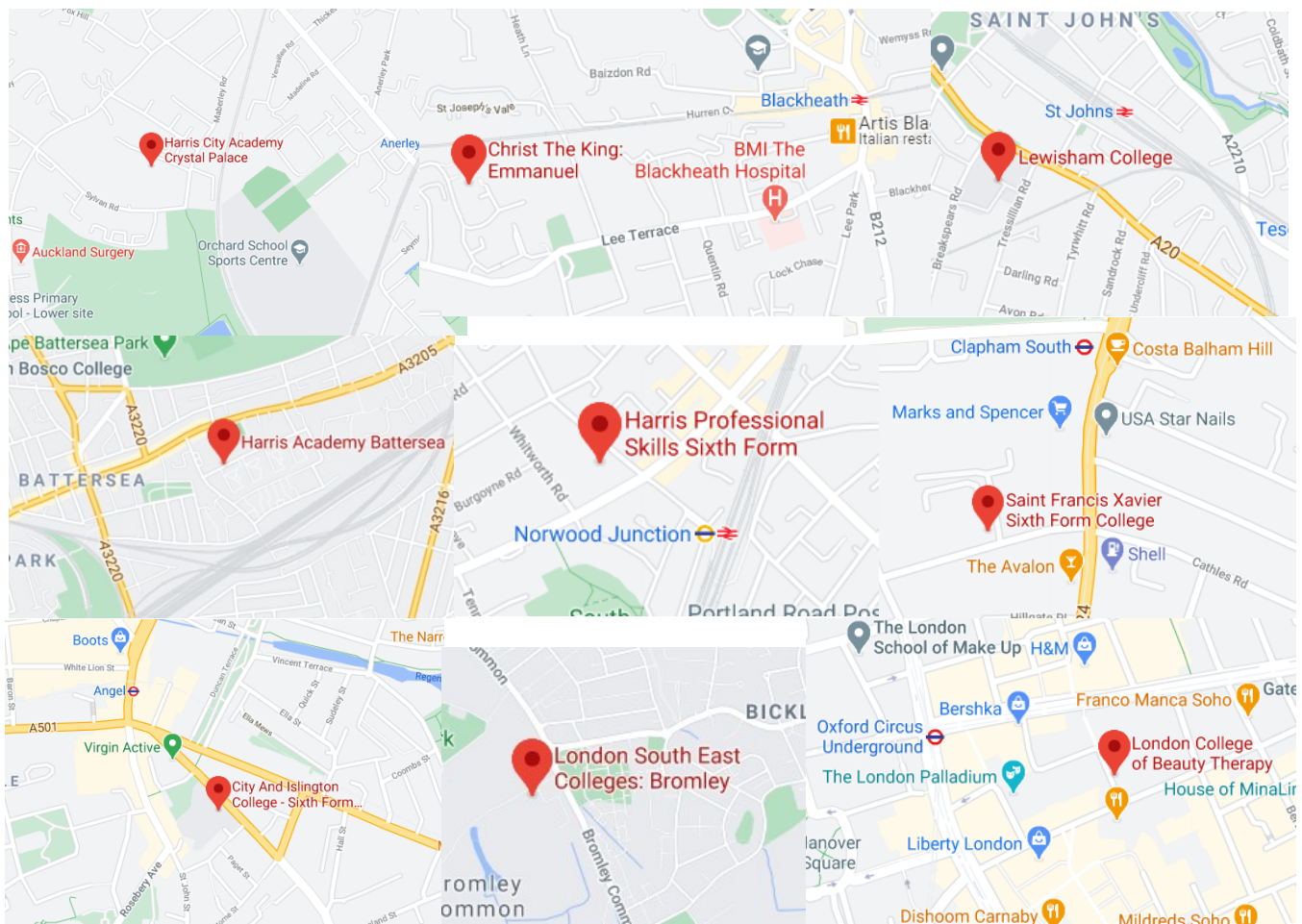

The next few pages will profile some of the colleges and Sixth Forms not in Lambeth, Southwark or Westminster that have previously been popular with OASB students. These profiles should give you an idea of what information to look up for other colleges you might be interested in. These pages do NOT cover all the colleges in London or all the factors that may make a college or Sixth Form right for you.

Make sure to do your own research!

Sixth Forms and Colleges Outside Three Main Boroughs - Quick guide

Remember that the best place to find more information is the school /Sixth Form/ college website.

You can compare schools on the government website - just search "Find and compare schools in England" and then search using your postcode and click '16 to 18' .

Destination Name	Postcode	Website	Best for	Specialist subjects	Required Grades
Harris Academy Crystal Palace	SE19 2JH	https://www.harriscrystalpalace.org.uk/	A-Levels Vocational/ Technical Courses Sporting Academy	Arts, humanities, sciences, sports academies	Grade 4s and 5s at GCSE
Harris Academy Battersea	SW11 5AP	www.harrisbattersea.org.uk	Academic A-levels	Art & Design, Spanish, Humanities	Grade 7 in chosen subjects Grade 5 in Maths and English
City and Islington College	EC1V 7LA	https://www.candi.ac.uk/	A-levels Wide range of BTECs	Public services	Grade 5s for A levels Grade 4s for BTECs
Harris Professional Skills Sixth Form	SE25 6EJ	https://www.harrisps6f.org.uk/	BTEC Level 3s BTEC Level 2s GCSE resits	Vocational courses— bricklaying, plumbing, joinery	Grade 4s in 4 subjects for BTEC Level 3 Just a letter of application for Level 1 or 2s
Saint Francis Xavier	SW12 8EN	www.sfx.ac.uk	A-levels BTEC Level 3s BTEC Level 2s BTEC Level 1s	Social sciences, vocational courses	Grade 5S in chosen subjects Grade 4s in Maths & English Grade 2s and 3s for Level 1/2 BTEC
Lewisham College (see Southwark College, previously merged)	SE8 4HH	https://www.lewisham.ac.uk/	BTEC Level 3s BTEC Level 2s BTEC Level 1s	Art, Business, Dance / drama, Health and Social care, Sciences, Computing, Media / Music, Travel & Tourism	Grade 4 in Maths Grade 4 in English Without these grades it is still possible to attend but resits would be required
Christ the King Emmanuel	SE13 5GE	https://www.ctk.ac.uk/	BTEC Level 3s BTEC Level 2s BTEC Level 1s	Sciences, Performing Arts, Arts, Business, Engineering	Grade 4 in Maths Grade 4 in English Without these grades it is still possible to attend but resits would be required
London South East Colleges	Sites in Bromley, Bexley, Greenwich, Orpington	https://www.lsec.ac.uk/	BTEC Level 3s BTEC Level 2s BTEC Level 1s	Full range of vocational courses	Grade 4 in Maths Grade 4 in English Without these grades it is still possible to attend but resits would be required
London College of Beauty Therapy	W1F 7LN	https://www.lcbt.co.uk/	BTEC Level 3s BTEC Level 2s BTEC Level 1s	Beauty	For Level 2 a good level of spoken and written English required. For Level 3 need to have completed Level 2

HARRIS ACADEMY BATTERSEA

Postcode: SW11 5AP

What they say about themselves

Ofsted Rating and previous results

Outstanding

Progress 8 Score
(Secondary): 0.64 (Well above average)

Average result (A-Levels):
C+

Average result (Broad vocational qualifications):
Merit+

Harris Academy Battersea is consistently the best performing Sixth Form in Wandsworth and one of the top sixth forms in London.

Rated OFSTED Outstanding (January 2018), our supportive Sixth Form develops aspirational young people to thrive in a changing world through our core values of knowledge, integrity and resilience.

We have high aspirations for all students and combined with a culture of academic rigour throughout the Sixth Form our students achieve success in whichever endeavour they choose.

We have a fantastic track record of supporting students to get into Russell Group Universities, with 40% of students going to these universities in our last year 13 cohort. The remainder also secured excellent opportunities through employment or apprenticeships. Two students went on to study in Dubai and the USA.

We work in partnership with our students to ensure a supportive and focused environment. Through outstanding pastoral care, expert teaching and the hard work of our students, we ensure that all our students achieve success.

What they specialize in

Mixes of BTECs and A-Levels

Maths, Sciences, Social Sciences
Humanities, Media, Photography,
Art

Business, Sport, Music, Performing
Arts, Health and Social Care

What grades you will need

A-Levels—Grade 7 in chosen subjects
Grade 5 in Maths and English

BTEC Level 3—five GCSEs grade 5+



The building

What the principal says

“Developing our young people both academically and personally is at the heart of everything we do at Harris Academy Battersea.

They should leave us not only having fulfilled their personal best in terms of academic results, but also equipped with our core values of knowledge, integrity and resilience to thrive in all stages of their lives.

Equally, we wish for our school and young people to serve the community and a school that the community is proud to have on its doorstep. The values embody the qualities we expect to see in our young people.”

Notes:

Do I want to make this one of my three options? Yes/No

Do I have the grades I need at the moment? Yes/No

What subjects do I need to improve in to successfully apply?

Have I submitted my application? Yes/No

CITY AND ISLINGTON COLLEGE

Postcode: EC1V 7LA

Ofsted Rating and previous results

Requires improvement

Average result (A-Level): C-

Average result (Broad vocational qualifications): Merit

Average result (T-Levels): Merit +

Apprenticeship achievement rate: 55.3%

What they say about themselves

At City and Islington College, we focus on providing training and education that:

- Is rigorously focused on creating the best outcomes for students
 - Enables and encourages all of our students to set their sights high and achieve their ambitions
 - Goes beyond qualifications; giving students the skills and qualities they need for long-term success in a global economy
 - Has a clear line of sight to employment
 - Is highly relevant, innovative and future-focused
- Is shaped by the needs of our community and employers

What they specialize in

Mixes of BTECs (L1-3) , A-Levels, T-Levels, Apprenticeships

Animal Care, Art, Design, Fashion, Childcare, Computing, Engineering, Languages, Health and Social Care, Beauty, Music, Science, Public Services, Sports

What grades you will need

A-Level—grade 5s English and Maths. 6s in subjects of interest

BTEC Level 3—grade 4s/5s in relevant subjects depending on the course

BTEC Level 2—three GCSEs including English Language/Mathematics at 3+



The building

What they say about life at CANDI

“At City and Islington College, we want to enrich your life with more than just qualifications. We want you to develop the broader range of skills and qualities employers’ look for, including communication, teamwork and problem-solving, as well as having a great time..”

Notes:

Do I want to make this one of my three options? Yes/No

Do I have the grades I need at the moment? Yes/No

What subjects do I need to improve in to successfully apply?

Have I submitted my application? Yes/No

HARRIS PROFESSIONAL SKILLS SIXTH FORM

Postcode: SE25 6EJ

Ofsted Rating and previous results

Good

Average result (A-Level):
C-

Average result (Broad vocational qualifications):
Merit

Average result (T-Levels): Merit

What they say about themselves

Harris Professional Skills Sixth Form is a unique new sixth form, established to provide an outstanding vocational education and preparation for skills-based work or transition to university for students in Croydon and the surrounding boroughs.

Part of the Harris Federation, which runs 47 highly successful primary and secondary academies across London, Harris Professional Skills Sixth Form caters for students who may not suit the traditional pathways at post-16. With small class sizes and strong pastoral support, we offer excellent, focused vocational options as well as the opportunity to take or resit GCSEs that you need to progress further – whether you choose to progress into a career or higher education.

What they say about their aims

“Harris Professional Skills Sixth Form will provide inspirational teaching. Students will be encouraged to develop and follow their own vocational interests, both within their chosen subjects and as part of the academy’s wider academic and cultural enrichment programme.

RESILIENCE, REFLECTIVENESS, RESOURCEFULNESS AND RECIPROCITY

In addition to the formal assessments that take place, students will also be assessed on Resilience, Reflectiveness, Resourcefulness and Reciprocity. indication of how the student approaches their studies and the level of determination to succeed.”

What they specialize in

Construction, Manufacturing, Business, Media

What grades you will need

BTEC Level 3—five subjects grade 4 including 3s In Maths and English

BTEC Level 1/2—Keen interest in programme as evidenced by 300 word letter setting out interest



The building

Notes:

Do I want to make this one of my three options? Yes/No

Do I have the grades I need at the moment? Yes/No

What subjects do I need to improve in to successfully apply?

Have I submitted my application? Yes/No

ST FRANCIS XAVIER SIXTH FORM COLLEGE

Postcode: SW12 8EN

Ofsted Rating and previous results

Good

Average result (A-Level): C

Average result (Broad vocational qualifications): Distinction-

Average result (T-Levels): Distinction

What they say about themselves

We believe every young person should have the opportunity to fulfill their educational potential.

A Sixth Form College with brilliant results, we offer a wide choice of A level, BTEC and UAL courses for 16-18 year olds. We are a diverse and compassionate community built upon a core Catholic Ethos that is reflected in our values. We warmly welcome students from all faiths, cultures and backgrounds.

Quality teaching and an enriched educational experience provide our students with the freedom to learn in their own way, underpinned by the support of our excellent teachers and dedicated learning, welfare and careers teams. Bridging the step between school and university, training or employment, we commit to developing our students personally and spiritually, and helping them succeed in all aspects of life.

What they specialize in

Any combination of their A-Level subjects

Weekly core religion and philosophy lessons

Sciences, Arts, Humanities, Languages, Literature, Social Sciences, Media, Travel and Tourism

What grades you will need

Interview needed

4 A-Levels/3 A-Levels —four GCSEs grade 7+, three at 6+/six GCSEs grade 4+

BTEC Level 3—six GCSEs grade 4+

BTEC Level 2—four GCSEs grade 3+

What current students say

“SFX is a vibrant and welcoming community where students are enabled to reach their full potential. It is a community built on Catholic values. Those values, which include inclusion and respect, and the college’s culture and ethics are equally as important to us as students as they are to the staff here.”

“At Saint Francis Xavier Sixth Form College, students are encouraged to speak their mind, to be unique, creative and to express themselves. The mission of the college is to prepare students for a future in work, education and life itself. We are all encouraged to fulfil our dreams through hard work and perseverance and any support needed is always readily available.”

Notes:

Do I want to make this one of my three options? Yes/No

Do I have the grades I need at the moment? Yes/No

What subjects do I need to improve in to successfully apply?

Have I submitted my application? Yes/No



The building

LONDON SOUTH EAST COLLEGES

Postcode: Bromley site—BR2 8HE

Ofsted Rating and previous results

Good

Average result (Broad vocational qualifications): Merit -

Average result (T-Levels): Merit +

Apprenticeship achievement rate: 50.4%

What they say about themselves

London South East Colleges is an award-winning further education college with eight campuses across south east London.

We know that education has a hugely positive impact on people's lives and are passionate about helping you to realise your potential. We are determined to make a difference to our local communities by providing high quality teaching and learning.

Our employment-focused vocational courses and affordable higher education courses are designed to help you gain the qualifications and skills that employers need. We will also help you to build the confidence you need to achieve your career ambitions

What they specialize in

A wide variety of level 1, 2 and 3 courses

Accounting, Aviation and Engineering, Arts, Beauty, Bookkeeping, Construction, Brickwork, Business, Travel and Tourism, Child-care, Catering, Computing, Media, Electrical Installation, Hairdressing, Health and Social Care, ICT, Motor Vehicle Maintenance, Nursing, Performing Arts, Plumbing, Public Services. Quantity Surveying, Science, Social Work

What grades you will need

Grade 4s in Maths and English, if not achieved these can be resat



The building

What they offer

Induction- A structured programme to help you settle into college life quickly.

Progress Coach- To help you with all aspects of your academic studies.

Student Hub- Providing you with guidance on the next level of study or any financial issues - find out more

Learning Support- Specialist help and resources for those in need of additional support.

Health and Wellbeing Providing sports, health and fitness facilities for all students.

Careers Advice- Professional advice on job hunting, CV preparation and university applications

Safeguarding- Protecting your welfare and keeping you safe from harm

Notes:

Do I want to make this one of my three options? Yes/No

Do I have the grades I need at the moment? Yes/No

What subjects do I need to improve in to successfully apply?

Have I submitted my application? Yes/No

Arts and Sport specialist courses

You should only consider applying to an Arts (Music, Drama) or Sports-specific course if you already spend your free time training or rehearsing and enjoy performing or competing regularly



- Location: near Stratford (about 45 minutes from Lambeth North)
- Subjects: **Music Performance, Film & TV, Game Design**
- Duration: Two-Year courses (full time only)
- Qualification: Level 3 Extended Diploma (equivalent to 3 x A Levels)
- You need to audition on an instrument if you are applying for the music course
- Places are very competitive
- www.elam.co.uk

- Location: Croydon (about an hour from Lambeth North)
- Subjects: **Music, Music Technology, Production, Art & Design, Theatre, Community Arts Practice, Dance, Film & Media**
- Duration: Two-Year courses (full time only)
- Qualification: Level 3 Extended Diploma (equivalent to 3 x A Levels)
- Places are very competitive
- You need to audition on an instrument if you are applying for the music, drama or dance courses
- <https://www.brit.croydon.sch.uk/>



**SOUTHWARK
COLLEGE**

- Location: Southwark
- Subjects: **Music and Drama**
- Qualifications: UAL Diploma in Performing and Production Arts: **Drama Pathway (Level 3)/ UAL Diploma in Music Performance and Production (Level 3) Programme**
- You need 4 x GCSEs at a 4 or above

- FOOTBALL EDUCATION SCHOLARSHIP ACADEMY Partnering with Lambeth Tigers FC at CRYSTAL PALACE NATIONAL SPORTS CENTRE
- Courses available in nutrition, coaching, football performance
- Level 3 Extended Diploma in Sport + FA Level 2 Football Coaching
- <https://www.lambethtigersfc.org/16-18-year-old-academy>



**SOUTHWARK
COLLEGE**

- Location: Lewisham
- Subjects: **Sports [Football] & Coaching**
- Qualification: BTEC First Extended Certificate in Sport (Level 2) Programme / CYQ L3 Diploma in Sport (Level 3) Programme
- You need 4 x GCSEs at a 4 or above
- <https://www.lscollge.ac.uk/courses/sport>

Apprenticeships

Most colleges provide apprenticeships - these are some of the most popular independent ones



Whitbread



Location: Various

Website: <https://www.whitbreadcareers.com/early-careers/apprenticeships/>

Best for: Hospitality

Required: Passion, team work, good communication

BT Group



Location: UK Wide

Website: <https://jobs.bt.com/content/Students-and-Graduates/>

Best for: Engineering and Tech

Required: 4 GCSEs grade 4-9 plus online test

Pimlico Plumbers



Location: London

Website: <https://www.pimlicoplumbers.com/recruitment/apprenticeships>

Best for: Plumbing (technical) & trade (business)

Required: Grade 5 Maths & English - practical skills

Sky



Location: London

Website: <https://careers.sky.com/earlycareers/apprenticeships/>

Best for: Technology, customer service, business, media

BAE Systems



Location: Various

Website: <https://www.baesystems.com/en/careers/careers-in-the-uk/apprenticeships>

Best for: Engineering

Required: Attention to detail, creativity, passion

British Army /Royal Navy/ Royal Air Force



Location: Various locations

Website: <https://apply.army.mod.uk/what-we-offer/regular-soldier/skills>

Best for: Range of topics: Public services, engineering, logistics

Busy Bees Childcare



Location: London

Website: <https://busybeestraining.co.uk/apprenticeships>

Best for: Childcare/catering

Required: Nurturing, patient

Toni & Guy

Location: London

Website: <https://toniandguy.com/careers/apprenticeships>

Best for: Hairdressing

Required: Attention to detail, passion

To find an apprenticeship look here: <https://www.gov.uk/apply-apprenticeship>

DO YOU KNOW WHAT BTEC
VOCATIONAL COURSE YOU
WANT TO STUDY BUT NOT
SURE WHERE?

USE OUR HANDY GUIDE ON
THE SCHOOL WEBSITE

[HTTPS://WWW.OASISACADEMYSOUTHBANK.ORG/UPLOADED/
SOUTH_BANK/ACADEMY_LIFE/NEXT_STEPS.PDF](https://www.oasisacademysouthbank.org/uploaded/south_bank/academy_life/next_steps.pdf)

OR GO TO THE SCHOOL WEBSITE, CHOOSE THE 'ACADEMY LIFE' TAB ,
SELECT 'YEAR 11 NEXT STEPS' AND FOLLOW THE LINK IN THE TEXT